

Variolink® Esthetic DC

Eingliederung von Inlays (Glaskeramik, Composite)

Einprobe

Variolink Esthetic Try-In

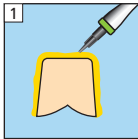

Auftragen der Try-In Paste

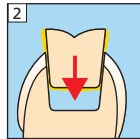

Einprobe der Restauration

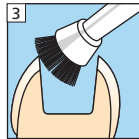

Reinigung nach der Einprobe

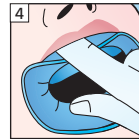

Trockenlegung

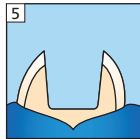

Restauration

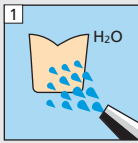

H₂O

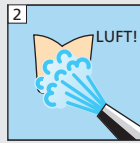

LUFT!

Vorbehandlung von Keramik-restaurationen:

Gemäss Herstellerangaben

Z.B. IPS Empress: 60 s ätzen

IPS e.max CAD/Press: 20 s ätzen

mit IPS Ceramic Ätzel (Flusssäure).

Sicherheitshinweise beachten.

Vorbehandlung von Composite-Restaurationen:

Gemäss Herstellerangaben

Z.B. SR Nexco, 2 bar, Al₂O₃ 100 µm

oder mit Finierdiamanten aufrauen.

Monobond Plus

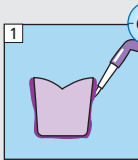

60 s

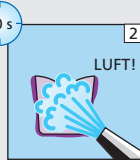

LUFT!



Adhese Universal

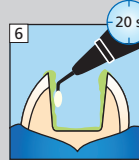

20 s



LUFT!

Pfützenbildung vermeiden



Bluephase Style

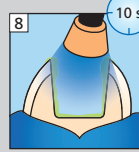

10 s

Befestigung

Variolink Esthetic DC

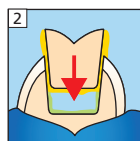
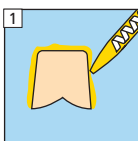

Bluephase Style

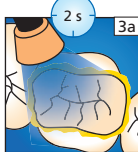

2 s

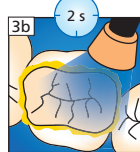

2 s

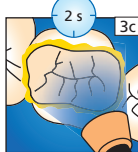

2 s

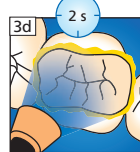

2 s

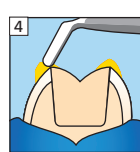

Restauration bis zum Ende der abschliessenden Polymerisation fixieren

Liquid Strip

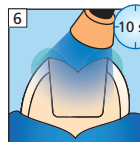
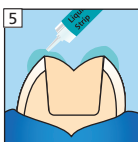

10 s*

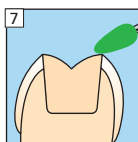

Polieren

Fluor Protector

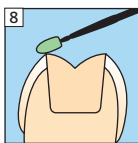

mehr Informationen unter www.cementation-navigation.com

CE 0123



Bitte Gebrauchsinformation beachten

ivoclar vivadent clinical

Erstellungsdatum: 2014-06-25
666356/d/Rev. 0

Variolink® Esthetic DC

Eingliederung von Kronen und Brücken
(Glaskeramik, Oxidkeramik, Composite)

Einprobe

Variolink Esthetic Try-In

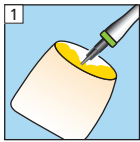

Auftragen der Try-In Paste

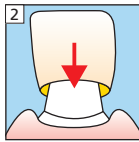

Einprobe der Restauration

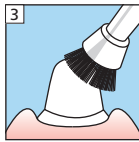

Reinigung nach der Einprobe

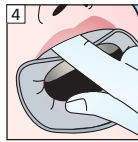

Trockenlegung

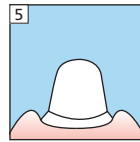

Restauration

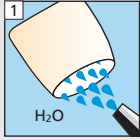

H₂O



LUFT!

Vorbehandlung von Glaskeramik-restaurationen:

Gemäss Herstellerangaben

Z.B. IPS Empress: 60 s ätzen

IPS e.max CAD/Press: 20 s ätzen

mit IPS Ceramic Ätzel (Flusssäure).

Sicherheitshinweise beachten.

Vorbehandlung von Oxidkeramik-restaurationen:

Gemäss Herstellerangaben

Z.B. IPS e.max ZirCAD

max. 1 bar, Al₂O₃ 100 µm

Vorbehandlung von Composite-Restaurationen:

Gemäss Herstellerangaben

Z.B. SR Nexco, 2 bar, Al₂O₃ 100 µm

oder mit Finierdiamanten aufrauen.

Monobond Plus

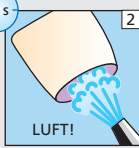
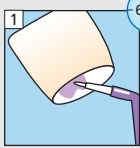

LUFT!

Total Etch:

optional

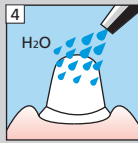
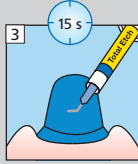

H₂O

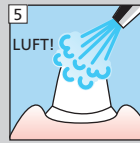

LUFT!

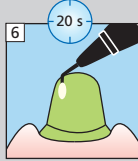

LUFT!



Pfützenbildung vermeiden

Bluephase Style

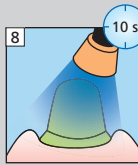

Befestigung

Variolink Esthetic DC

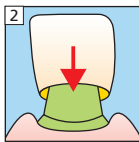
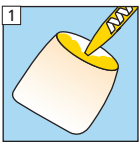

Bluephase Style

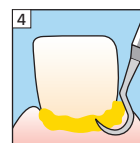
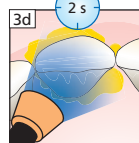
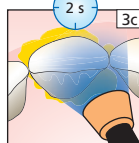
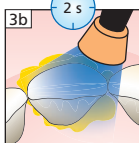
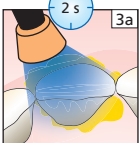

Restauration bis zum Ende der abschliessenden Polymerisation fixieren

Liquid Strip

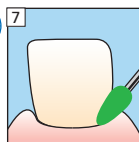
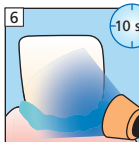
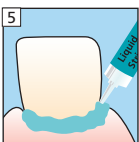

* pro Segment und mm Keramik

Polieren

Fluor Protector

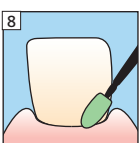

mehr Informationen unter
www.cementation-navigation.com

CE 0123



Bitte Gebrauchsinformation beachten

ivoclar
vivadent
clinical